

Directions and Parking Instructions

Phone: (919) 613-6976

The Duke Canine Cognition Center is located on Duke University's West Campus in the Biological Sciences Building (130 Science Drive, Biological Sciences Room 001, Durham, NC 27708). We have a reserved parking spot labeled RSDV 0077 in the Chemistry Lot next to the DCCC. **In order to enter the gated parking lot, please print and use the parking pass attached to your confirmation email (see detailed scanning instructions on the next page).** If you are not able to print the parking pass, please let us know in advance so we can meet you at the gate to let you in. Please call the lab if you encounter problems entering the parking lot. On evenings after 5 pm and weekends, you may park in any unmarked spot on campus. Therefore, if the reserved spot is occupied upon arrival after 5pm, please park in any unmarked spot.

Directions to Duke University's West Campus:

From US-15/501: Take exit 107 onto NC 751/Cameron Boulevard. Go east on Cameron Boulevard to Science Drive. Turn left onto Science Drive. Then turn left onto Towerview Road and right onto West Circuit Drive. The Chemistry Lot will be on your right.

From NC-147/Durham Freeway: Take exit 13 onto West Chapel Hill Street. Go west on West Chapel Hill Street. After it turns into Duke University Road, turn right onto Towerview Road. Turn right at West Circuit Drive. The Chemistry Lot will be on your right.

From I-85: Take exit 174B for US 15/501 towards Chapel Hill. Take exit 108C-B-A for NC-147 towards Moreene Road. Exit onto Moreene Road. Turn left onto Moreene Road. After it turns into Towerview Road, turn left onto West Circuit Drive. The Chemistry Lot will be on your right.

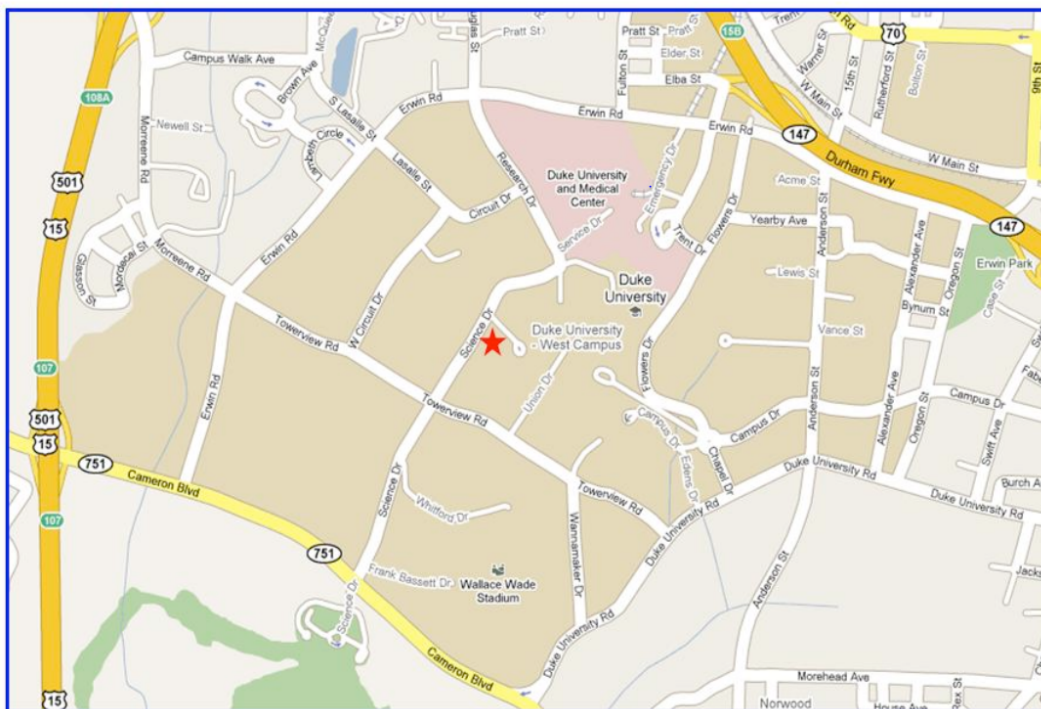

Primary Parking: Instructions to Chemistry Parking Lot

Please use these instructions to park at the Chemistry Parking Lot unless otherwise instructed to use the Bryan Center Parking Garage.

From Towerview Rd, you will turn onto Circuit Drive across from Fuqua Drive. Turn right into the Chemistry Lot and **locate the glass scanner, which is next to the ID card reader. The scanner may emit a red laser like what is used at cash registers. Scan the barcode located at the top right of the parking pass until the device displays “Working...” and the gate lifts.** Please call us if you have difficulty entering.

Once in the lot, continue to the end and stay to the left at the first fork in the road. You will go down a small hill and should see the greenhouses right in front of you. Stay to the right of the greenhouses, and our designated parking spot will be on your right and at the far end of this lot. Our spot is labeled with our Duke Canine Cognition sign. The star on the diagram represents the parking space, RSVD 0077. Place the parking pass on your dashboard, and write today’s date next to “Valid Date”. You will need to scan the pass again to exit the lot.

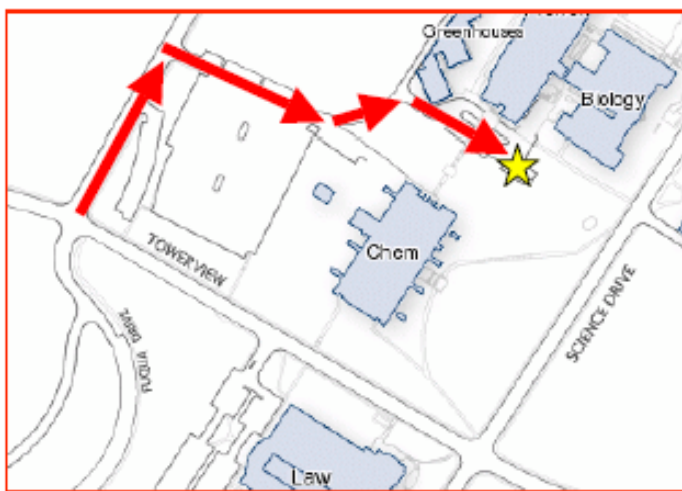

Upon parking in the designated spot, face the loading dock and walk toward the building. Look for a long path on the grass leading towards Science Drive, and a short path branching off the long path leading to a door in the side of the building. Follow this path to the door, and enter the building. Enter the door past the staircase, and the Duke Canine Cognition Center will be on your left!

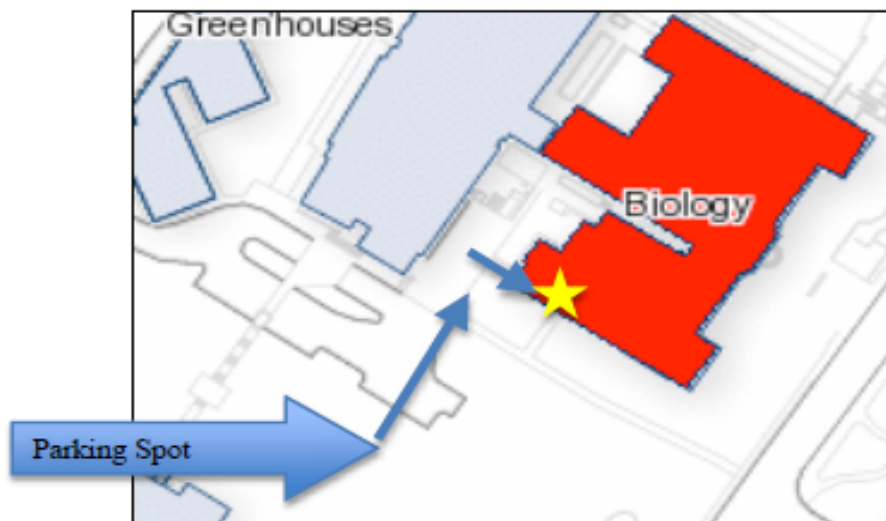

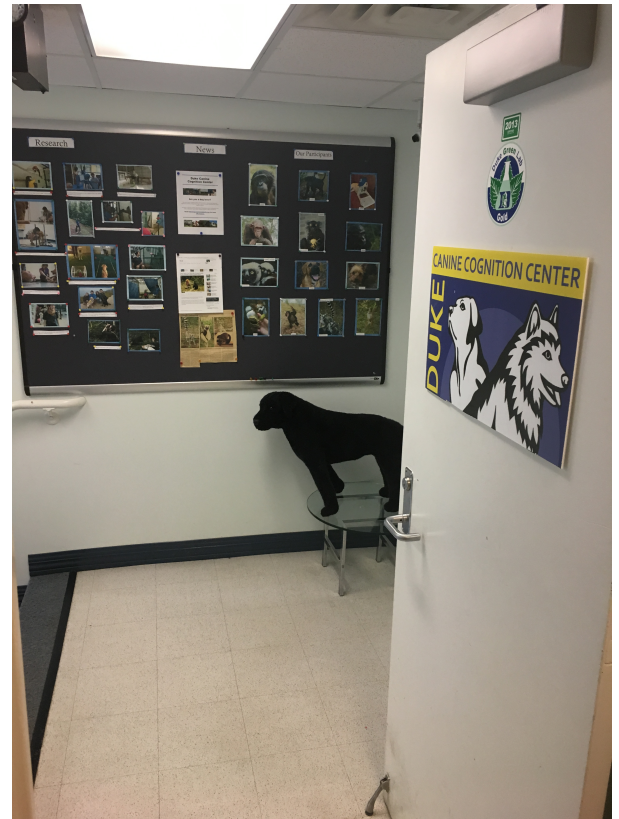
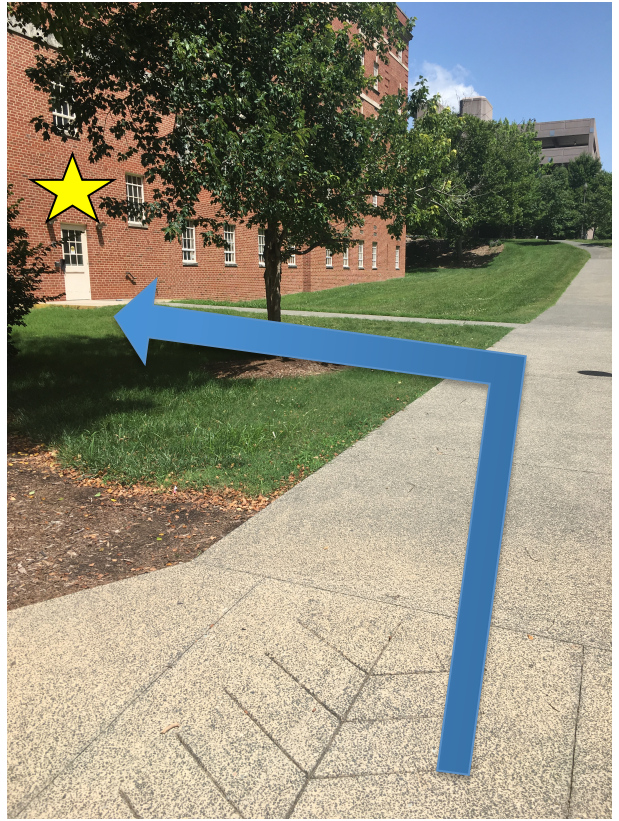

Secondary Parking: Instructions to the Bryan Center Parking Garage

Please use the Bryan Center Parking Garage only if you are instructed to park there or if you encounter problems parking in the Chemistry Lot.

The **Bryan Center Parking Garage** is located on **Science Drive**. If you park here, you will receive a parking pass from the DCCC before you leave so that you will not have to pay for parking. The map below shows how to get from the Bryan Center Parking Garage to the DCCC.

Our lab is located in the **subbasement of the Biological Sciences building**, and is actually accessible outdoors by walking down the hill. You'll see a side door on your right. Please enter this side door, walk through the door past the stairs, and the DCCC will be on your left!

If you cannot locate the entrance please call us at **919-613-6976**.

